

LEARNING CENTRE (CLASSROOM)

13 62 11
ausco.com.au

12.0 X 17.25 (5 MODULES)



LCV1217



STANDARD INCLUSIONS:

- > 2 learning rooms (62.94 m²), 2 Preparation rooms (15.3 m²) and covered verandah (41.38 m²)
- > 2 external plain metal doors 2043 x 886
- > 17 windows various sizes (with flyscreens)
- > 20 diffused LED batten lights, 38W (internal)
- > 4 vandal resistant lights (external)
- > 14 double socket GPO's, 10 amps
- > 5 single socket GPO's, 10 amps (for AC's)
- > 5 Wall Mount Air Conditioners, 2HP

STANDARD FINISHES:

Exterior:

- > Trimdeck® roof cladding (Surfmist)
- > CCS Mesa cladding to exterior walls (Merino)
- > R1.5 glasswool batts (ceiling), R2.0 glasswool batts (walls)

Interior:

- > Pre-finished polyester plywood linings to ceilings (Mirage Pearl)
- > Painted interior walls (White Smoke)
- > Seamless vinyl floor coverings (Neutral Grey) to remainder of building
- > D Mould cornice & skirtings throughout

LEARNING CENTRE (CLASSROOM)

12.0 X 17.25
(5 MODULES)

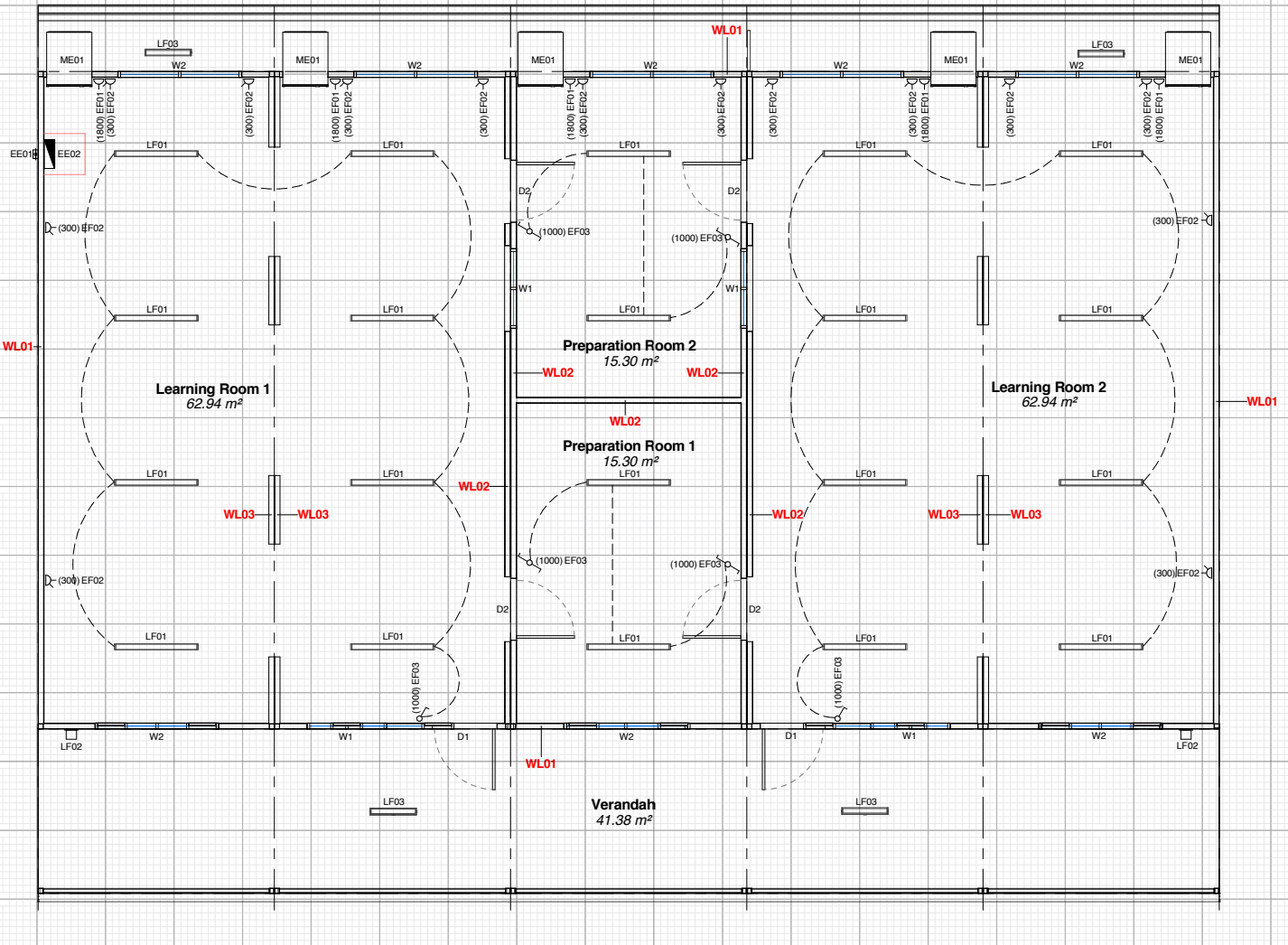

OTHER DESIGN OPTIONS

At Ausco, we understand that you may want to tailor your building to the unique needs of your business. For information about structural, complexing and design options available (including finishes, fixtures, fittings and cladding options) for this building, please contact your local Ausco representative.

13 62 11
ausco.com.au

